

**RESTORATION OF THE SECTION CORNER  
COMMON TO  
SECTIONS 7 AND 18, TOWNSHIP 1 SOUTH, RANGE 10 WEST  
AND SECTIONS 12 AND 13, TOWNSHIP 1 SOUTH, RANGE 11 WEST**

Record #1: July 1856, Corner established by Samuel D. Snowden under contracts No. 66 and 67; 80 chains set post for corner, from which:

A Spruce, 16" dia. bears North 47° East 41 links dist.;  
A Spruce, 48" dia. bears North 63° West 25 links dist.;  
A Spruce, 8" dia. bears South 47° West 32 links dist.; and  
A Spruce, 8" dia. bears South 77° East 50 links dist.

Record #2 July 1887, Robert R. Hays, South 1 chain "established the sec. cor.", set basalt stone 22" x 18" x 9" for corner, from which:

A Spruce, 40" dia. bears North 39° East 12 links dist.;  
A Spruce, 30" dia. bears South 38° East 34 links dist.;  
A Spruce, 8" dia. bears South 71° West 70 links dist.; and  
A Spruce, 10" dia. bears North 57° West 116 links dist.

**EVIDENCE:**

No evidence of Snowden's corner, post or bearing trees were found, and very likely Hays could not find it in 1887. No evidence of Hays' corner stone or bearing trees were found either. It is apparent on the ground that the 40" bearing tree to the Northeast fell over the cliff, leaving a large hole in the ground adjacent to and North of the corner location. This probably destroyed the corner stone. There are many stones in the area, most of them in the bottom of the hole, but none with any chisel marks. It also appears that the 30" bearing tree to the Southeast fell over the cliff. No evidence of Hays Southwest bearing tree was found. There is a large spruce tree near the location of Hays 10" bearing tree to the Northwest, but it did not date back far enough when we checked it. It is growing out of a log over the creek, and no evidence of a face was seen on the log.

**MONUMENTATION**

At 66.00 feet South 0° 07' 57" West from the found Meander Corner, and on line with the 1/4 corner 1/2 mile to the south (see attached sketch), set a 3" aluminum cap stamped "T1S R11W R10W S12 S7 S13 S18 LS1979 1990" on a 2" aluminum pipe 30" long, 24" in ground, with a 5/8" x 30" rebar inside, in rock mound, approximately 5 feet East of small creek.

**CORNER ACCESSORIES:**

Meander corner 66.00 feet North 0° 07' 57" East, see corner restoration same date.

New bearing tree, scribed 36" dia. Spruce "T1S R11W S12 BT" on long face with brass nail and washer stamped "LS 1979" at bottom face, bears North 77° 19' West 38.62 feet to nail and washer.

New bearing tree, scribed 22" dia. Spruce "T1S R10W S18 BT" on long face with brass nail and washer stamped "LS 1979" at bottom face, bears South 32° 35' East 28.21 feet to nail and washer.

New bearing tree, scribed 18" dia. Spruce "T1S R10W S7 BT" on long face with brass nail and washer stamped "LS 1979" at bottom face, bears North 69° 59' East 33.08 feet to nail and washer.

No suitable bearing tree was available in the Southwest quadrant, within a reasonable distance.

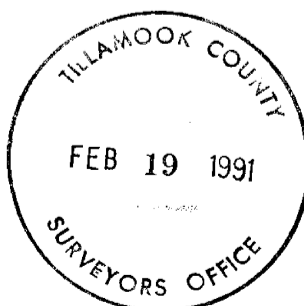
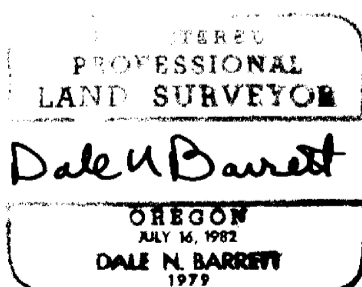

SEE Book 7, Pg. 54  
SEE Book 7, Pg. 54

**NOTES:**

Bearing are based on the line between the two Tillamook County Brass Caps in the centerline of Fourth Street as shown on map A-5793 which bears North. Meander corner to said monument in the centerline of 4th Street and Pacific Avenue is North  $52^{\circ} 22' 54''$  East 3100.47 feet.

Corner remonumented on Dec. 11, 1990.

Present: Dale N. Barrett, Prof. Land Surveyor  
Terry L. Jones, Survey Technician  
John P. Robinson, Asst. Survey Technician  
Chris D. Dillard, Asst. Survey Technician

Equipment: Topcon GIS-3, co-op 41 Data Collector.

SEE Book 7, Pg. 54  
SEE Book 7, Pg. 56

